

KEY:

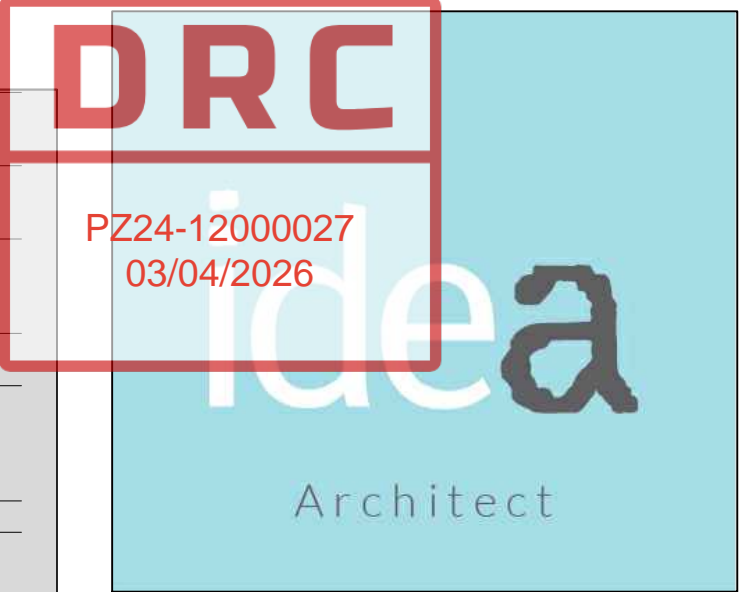
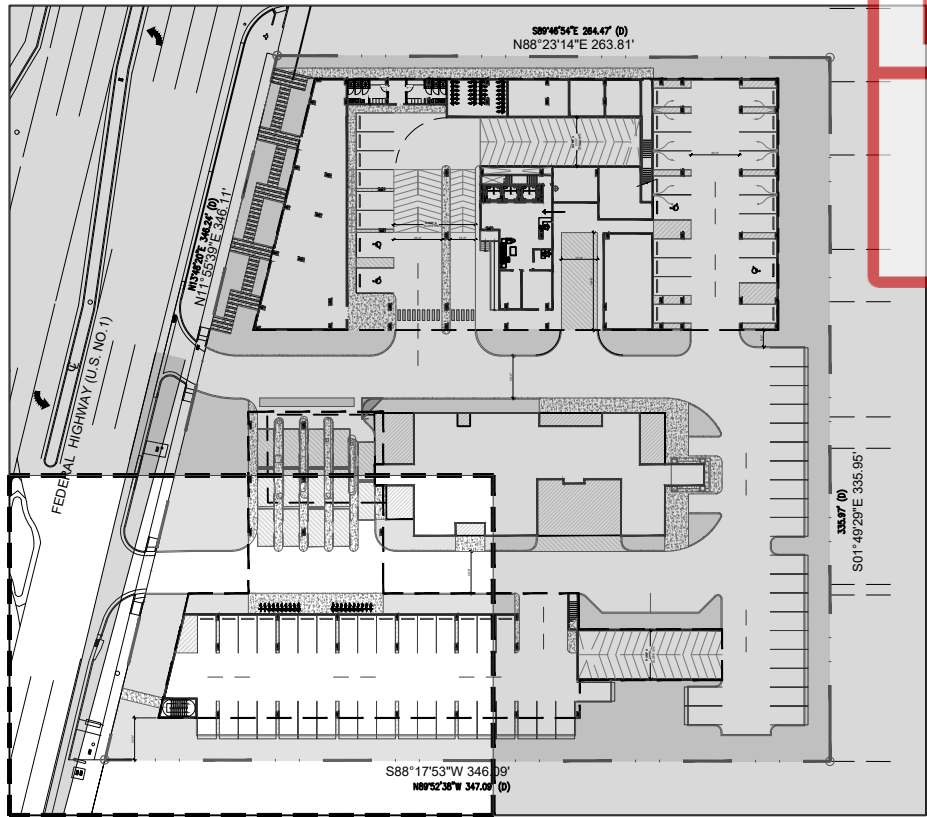

absolute-idea.com

CANAL PARK
3323 NE 163rd Street, Suite 200 North Miami Beach, FL 33160
305.792.0015 305.931.0279 info@absolute-idea.com

HARDSCAPE SCHEDULE					
MATERIALS					
KEY	DESCRIPTION	MANUFACTURER	COLOR	FINISH	SIZE
1	Concrete	Contractor	Grey	Standard	See civil
2	Concrete Paver	TBD	TBD	TBD	TBD

SILVA CELL

SEAL

KEN GARDNER
FLA 1569

TO THE BEST OF MY KNOWLEDGE, THE PLANS AND SPECIFICATIONS COMPLY WITH THE APPLICABLE MINIMUM BUILDING CODES AND THE APPLICABLE PROFESSIONAL STANDARDS AND REQUIREMENTS OF THE JUDICIAL COUNCIL OF FLORIDA. I AM NOT PROVIDING ANY GUARANTEE OR WARRANTY FOR THE WORKS SHOWN HEREIN.

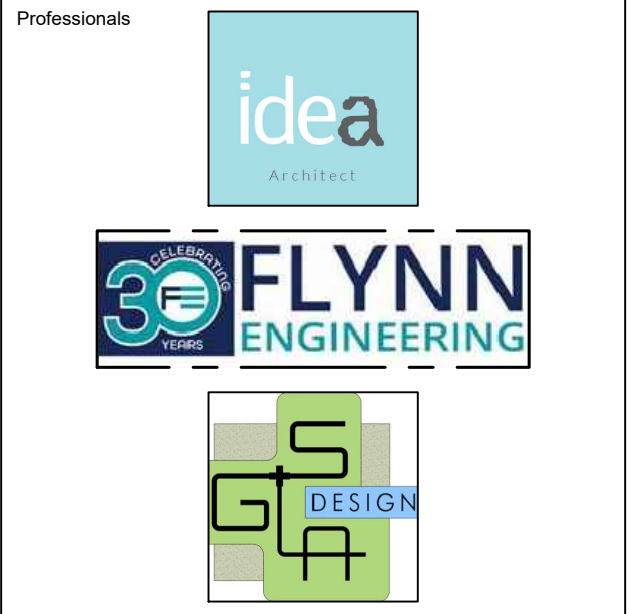

REV.	DATE	DESCRIPTION
01	XX-XX-2024	D.R.C SUBMITAL

ALL MEASUREMENTS MUST BE VERIFIED BEFORE BEGINNING THE WORKS. NO MEASUREMENTS ARE TO BE SCALED DIRECTLY FROM THIS DRAWING.

Key section

Client

VERA FUND
NICK POLYUSHKIN
& YURI KHARITONENKOV
TEL: 305.833.3303

Project

**1600 S FEDERAL HIGHWAY
(MIXED-USE PROJECT)**

1600 SOUTH FEDERAL HIGHWAY,
POMPANO BEACH, FL 33062

Title			
HARDSCAPE PLAN GROUND FLOOR			
Drawn	Field		
GSLA	LANDSCAPE ARCH		
Verified	Scale		
KG	as shown		
Approved	Date		
KG	10-09-2024		
Project Manager	Dwg. no.		
KG	L-103		
Project			
24-838			

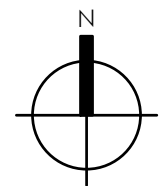

HARDSCAPE PLAN - GROUND FLOOR

40' 20' 10' 0' 1/103
SCALE: 1" = 10'